



701 E Industrial PK Dr  
Manchester NH 03109  
877-364-8464  
www.sunsettrading.com  
info@sunsettrading.com

\*\*Pls Check to make sure you have all parts otherwise contact local retailer or Sunset Trading customer service at 877-364-8464"

Thank You for purchasing this Quality product. It has been engineered for easy assembly yet constructed for durability. Please take the time to read and follow the instruction while assembling.

# ASSEMBLY INSTRUCTION

## Round Pedestal Butterfly Table

47" x 48"L x 66 x 30"H

Sunset Trading®

a div of Sunset Furniture Intl.LLC

Model : DLU-ADW-TPB-4866

Step 1

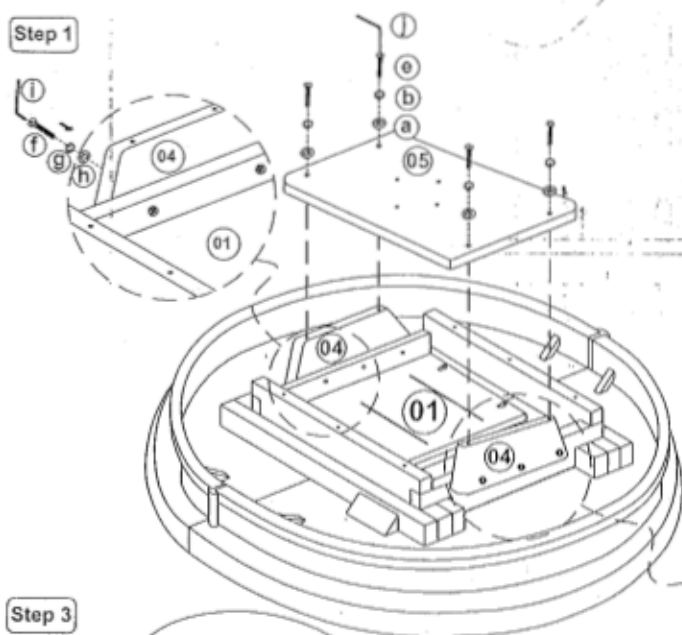

Step 3

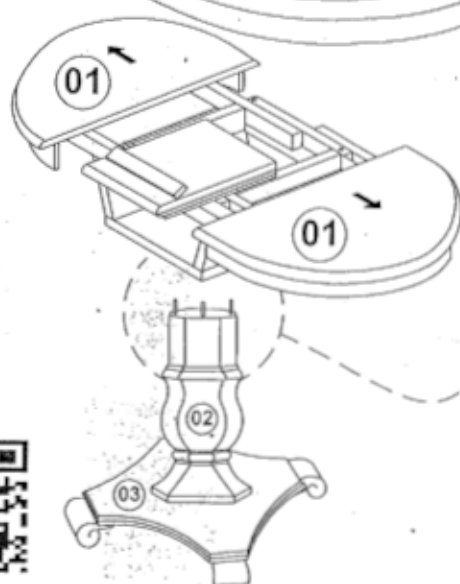

Step 2

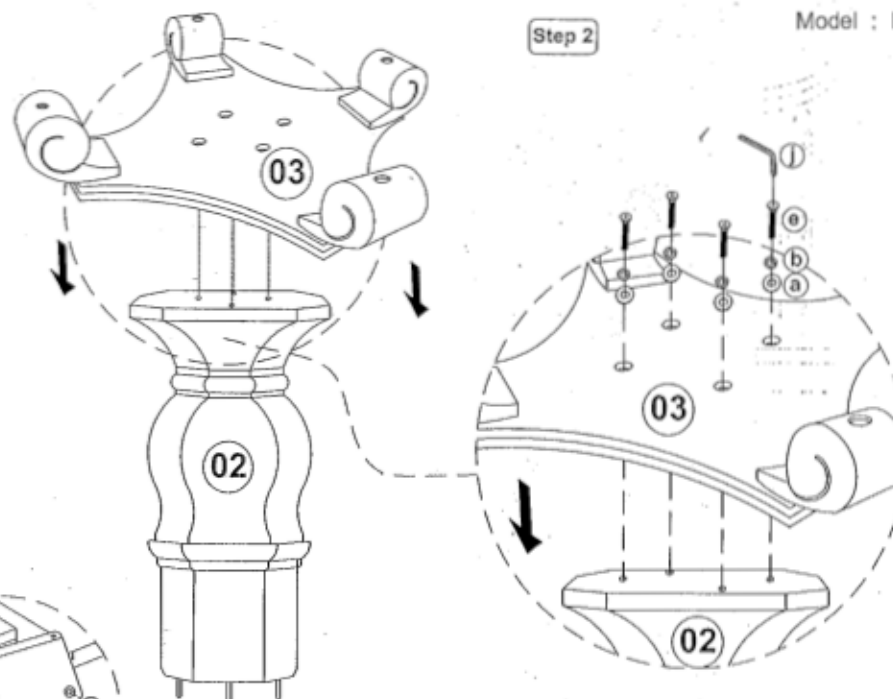

Step 4

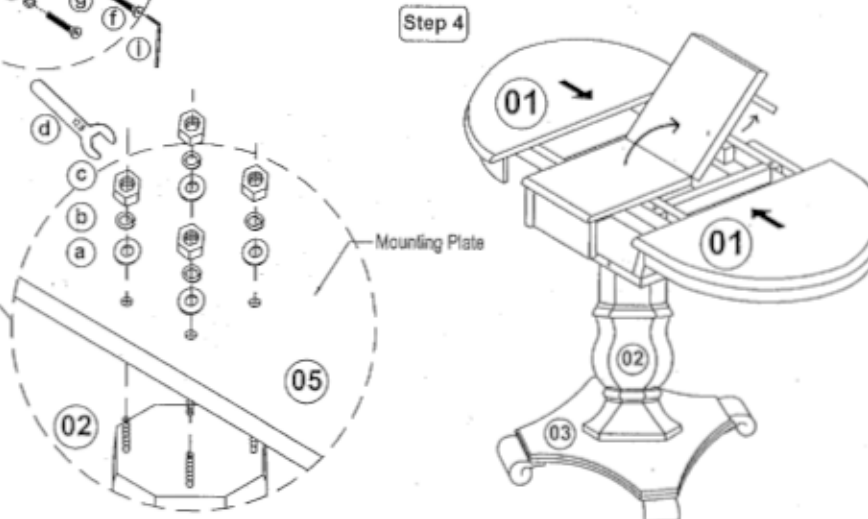

List of Part For 1 Set

01	Table Top	1
02	Pedestal	1
03	Bottom Panel	1
04	Supporting Rail	1
05	Mounting Plate	1

List of hardware For 1 Set

a	Flat Washer 5/8" x 22mm	12
b	Spring Washer 5/8"	12
c	Hexagon Nut 5/8" x 7mm	4
d	Spanner 12.8mm	1
e	JCBC Bolt M8 x 40mm	8
f	JCBC Bolt M6 x 40mm	6
g	Spring Washer 1/2"	6
h	Flat Washer 1/2" x 13mm	6
i	Allen Key M4	1
j	Allen Key M5	1

### Important Notes

- Keep all hardware parts out of reach of children.
- Must tighten screws periodically. With use screws will become loose. Check tightness of all screws every 6-8 week.
- Don't attempt to repair or modify parts that are broken or defective. Please contact the store immediately.
- Do not tighten all screw / bolt until all completely assembled



MADE IN MALAYSIA Assembly Completed

